

Aqua-Pure[®]

Installation and Operating Instructions For Standard Sized Whole House Water Filters: AP055 Series

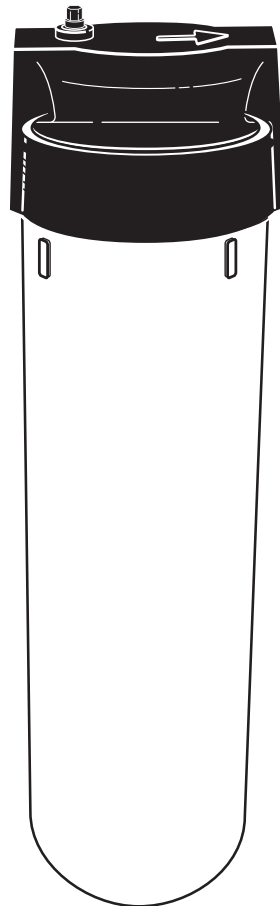

**Installer: Please leave manual with homeowner.
Homeowner: Please retain for operation and
future maintenance instructions.**

6998031 1111

3M

SAFETY INFORMATION

Read, understand, and follow all safety information contained in these instructions prior to installation and use of the Aqua-Pure® Standard Sized Whole House Water Filters. Retain these instructions for future reference.

Intended use:

AP055 Series Whole House Water Filters are intended for use in filtering potable water in homes and have not been evaluated for other uses. These filters are typically installed at the point of entry, and should be installed by qualified professional installers according to these installation instructions.

| EXPLANATION OF SIGNAL WORD CONSEQUENCES | |
|--|---|
|  WARNING | Indicates a potentially hazardous situation, which, if not avoided, could result in death or serious injury and/or property damage. |
| CAUTION | Indicates a potentially hazardous situation, which, if not avoided, may result in property damage. |

|  WARNING |
|--|
| To reduce the risk associated with choking: <ul style="list-style-type: none">• Do not allow children under 3 years of age to have access to small parts during the installation of this product. |
| To reduce the risk associated with ingestion of contaminants due to use with water that is microbiologically unsafe or of unknown quality: <ul style="list-style-type: none">• Do not use with water that is microbiologically unsafe or of unknown quality without adequate disinfection before or after the system. |
| To reduce the risk of physical injury: <ul style="list-style-type: none">• Depressurize system as shown in manual prior to cartridge removal. |
| To reduce the risk associated with hazardous voltage: <ul style="list-style-type: none">• If the home electrical system requires use of the cold water system as an electrical safety ground, a jumper must be used to ensure a sufficient ground connection across the system installation piping — refer installation to qualified personnel. |

CAUTION

To reduce the risk associated with property damage due to water leakage:

- **Read and follow** Use Instructions before installation and use of this system.
- Installation and Use **MUST** comply with all state and local plumbing codes.
- **Protect from freezing.** Drain filter when temperatures drop below 40°F (4.4°C).
- **Do not** install systems in areas where ambient temperatures may go above 110°F (43.3°C).
- **Do not** install on hot water supply lines. The maximum operating water temperature of this system is 100°F (37.8°C).
- **Do not** install if water pressure exceeds 125 psi (862 kPa). If your water pressure exceeds 80 psi, you **must** install a pressure limiting valve. Contact a plumbing professional if you are uncertain how to check your water pressure.
- **Do not** install where water hammer conditions may occur. If water hammer conditions exist you must install a water hammer arrester. Contact a plumbing professional if you are uncertain how to check for this condition.
- Where a backflow prevention device is installed on a water system, a device for controlling pressure due to thermal expansion must be installed.
- **Do not** use a torch or other high temperature sources near system, cartridges, plastic fittings or plastic plumbing.
- On plastic fittings, never use pipe sealant or pipe dope. Use PTFE thread tape only, pipe dope properties may deteriorate plastic.
- Take care when using pliers or pipe wrenches to tighten plastic fittings, as damage may occur if over tightening occurs.
- Do not install in direct sunlight or outdoors.
- Do not install near water pipes which will be in path of a drilling tool when selecting the position to mount the bracket.
- Mount system in such a position as to prevent it from being struck by other items used in the area of installation.
- Ensure that the location and fasteners will support the weight of the system when installed and full of water.
- Ensure all tubing and fittings are secure and free of leaks.
- DO NOT leave valve-in-head models in "OFF" position for an extended period of time or use as a substitute for main water line valve if line must be shut off for servicing.
- SHUT OFF FUEL OR ELECTRIC POWER SUPPLY TO WATER HEATER after water is shut off.
- The disposable filter cartridge **MUST** be replaced every 6 months, at the rated capacity or sooner if a noticeable reduction in flow rate occurs.

IMPORTANT NOTES

- Failure to follow instructions will void warranty.
- Allow a minimum of 2" (5 cm) clear space under filter to facilitate cartridge change.
- Install with the inlet and outlet ports as labeled. Make sure not to reverse connections.

GETTING STARTED

Tools and Materials Required (not included):

- A) Wrench
- B) Tube Cutter
- C) PTFE Tape
- D) 4 Brass Locking Nuts
- E) 4 Brass Ferrules
- F) 2 Male Compression Adapters
- G) Compression Ball Valve (Optional)
- H) Filter Cartridge

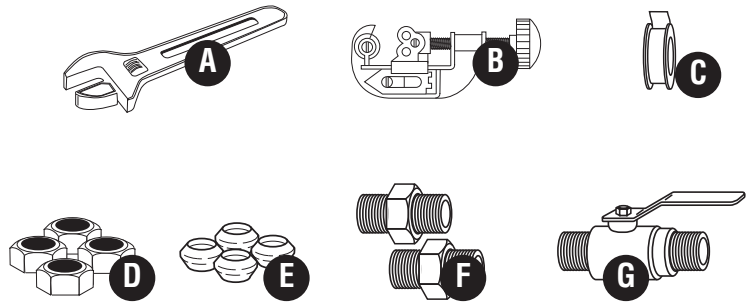

IMPORTANT INSTALLATION INSTRUCTIONS

CAUTION

To reduce the risk associated with property damage due to water leakage:

- Install on **COLD** water lines only. (40-100°F (4.4-37.8°C))
- Shut off fuel supply to water heater after water is shut off.

IMPORTANT NOTES

- Before starting, shut off main water supply and drain pipes.
- Allow a minimum of 2" (5 cm) clear space under filter to facilitate cartridge change.
- Install with the inlet and outlet ports as labeled. Make sure not to reverse connections.

1. Loose fit all component parts and calculate length of pipe to be removed.
2. Cut appropriate length of pipe.
3. Apply PTFE tape to threads of both male compression adapters, then rotate each into filter housing. Make a tight connection but do not overtighten.
4. Place brass locking nuts and ferrules as shown in the diagram.
5. Place filter housing (with filter cartridge inside) with male compression adapters onto incoming and outgoing plumbing. Make sure you correctly align the "IN" end of the housing with the incoming water line as shown below. Tighten locking nuts securely with the wrench.
6. Slowly turn water supply on, open shut-off valve and check for leaks.

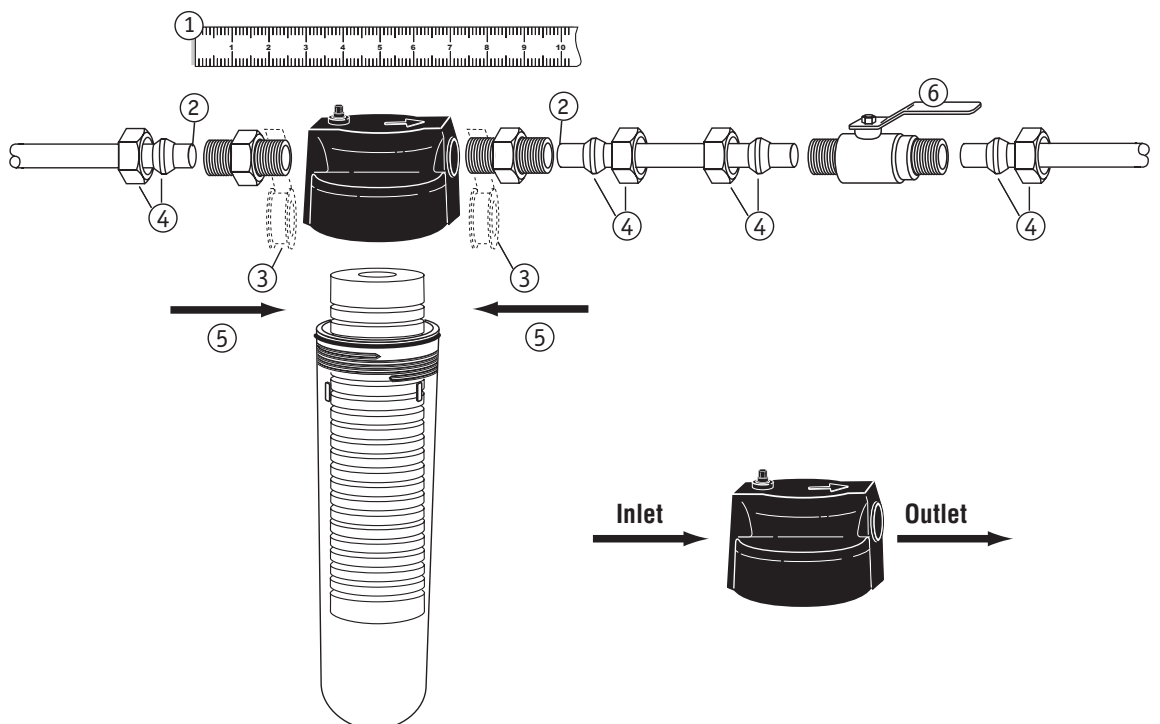

FILTER CARTRIDGE REPLACEMENT INSTRUCTIONS

CAUTION

To reduce the risk associated with property damage due to water leakage:

- The disposable filter cartridge MUST be replaced every 6 months, at the rated capacity or sooner if a noticeable reduction in flow rate occurs.

1. Shut off inlet and outlet valves, depress pressure relief button on top of filter head to relieve pressure in filter.
2. Unscrew housing to the left from the filter head and remove cartridge, emptying water from housing.
3. Clean and inspect all components. Lubricate o-ring with a silicone based lubricant or water. Do not use Petroleum Based Lubricants. Replace o-ring seal if there is visible damage.
4. Install new cartridge into housing.
5. Place lubricated o-ring on the housing. Screw housing to the right firmly onto head until a definite stop is felt and cartridge is sealed. Hand tight is sufficient. However, be sure not to overtighten or force housing.
6. Turn on inlet valve and depress pressure relief button until air is purged from filter. Release button and turn on outlet valve.

CAUTION

- DO NOT leave valve-in-head models in "OFF" position for an extended period of time or use as a substitute for main water line valve if line must be shut off for servicing.

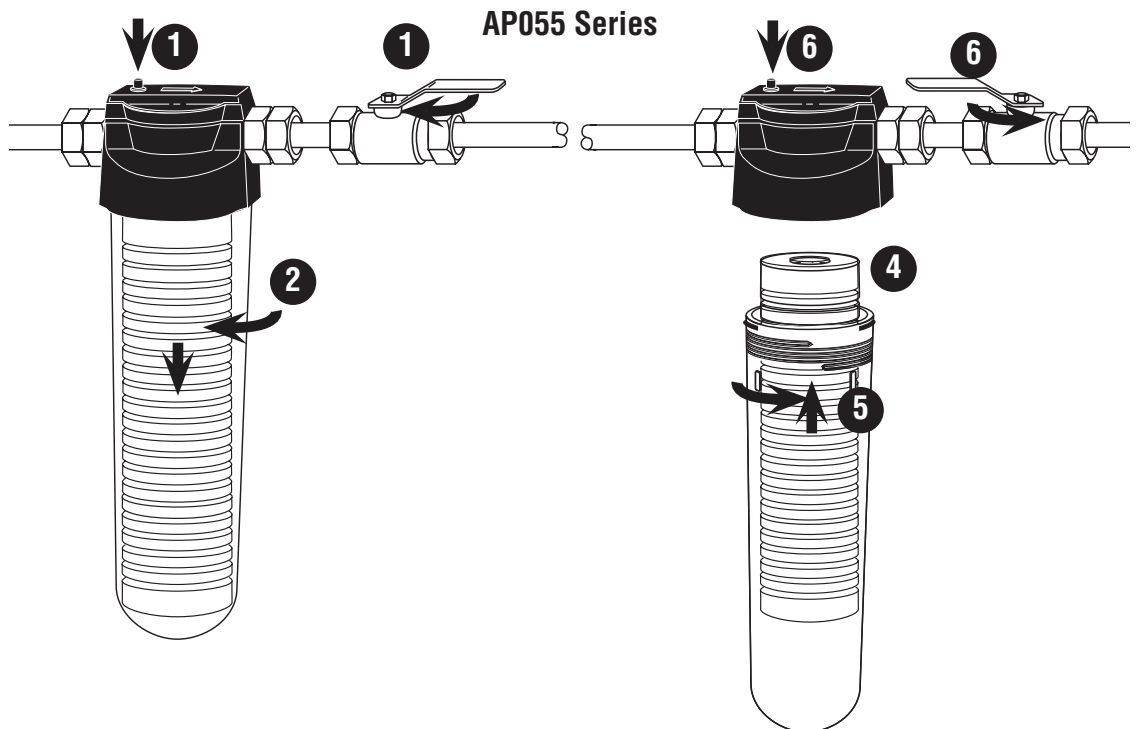

REPLACEMENT PARTS

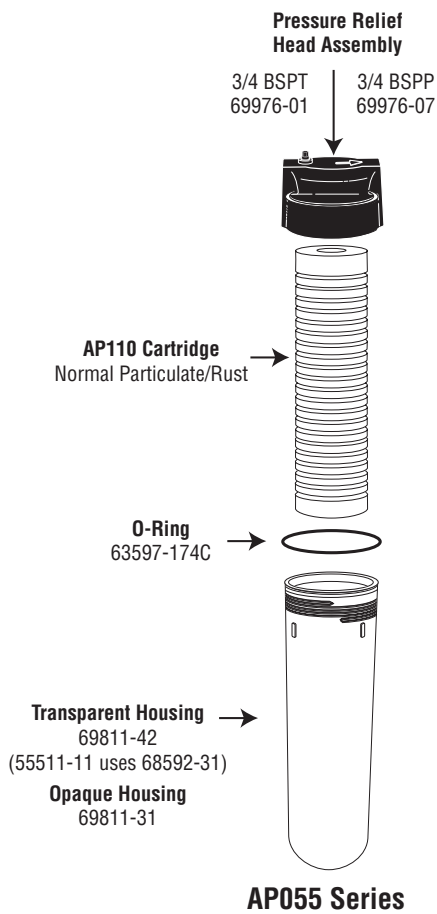

Available Cartridges

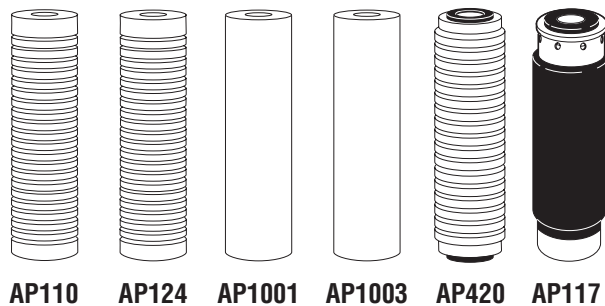

LIMITED WARRANTY

3M Purification Inc. warrants this Product (excluding disposable filter cartridges(s)) will be free from defects in material and manufacture for ten (10) years from the date of purchase. The disposable filter cartridge or membrane is warranted from defects in material and manufacture for a period of one (1) year from the date of purchase. This warranty does not cover failures resulting from abuse, misuse, alteration or damage not caused by 3M Purification Inc. or failure to follow installation and use instructions. No warranty is given as to the service life of any filter cartridge or membrane as it will vary with local water conditions and water consumption. **3M PURIFICATION INC. MAKES NO OTHER WARRANTIES OR CONDITIONS, EXPRESS OR IMPLIED, INCLUDING, BUT NOT LIMITED TO, ANY IMPLIED WARRANTY OR CONDITION OF MERCHANTABILITY OR FITNESS FOR A PARTICULAR PURPOSE OR ANY IMPLIED WARRANTY OR CONDITION ARISING OUT OF A COURSE OF DEALING, CUSTOMER OR USAGE OF TRADE.** If the Product fails to satisfy this Limited Warranty during the warranty period, 3M Purification Inc. will replace the Product or refund your Product purchase price. This warranty does not cover labor. **The remedy stated in this paragraph is Customer's sole remedy and 3M's exclusive obligation.**

This warranty gives you specific legal rights, and you may have other rights which may vary from state to state, or country to country. For any warranty questions, please call 1-800-222-7880 or mail your request to: Warranty Claims, 3M Purification Inc., 400 Research Parkway, Meriden, CT 06450. Proof of purchase (original sales receipt) must accompany the warranty claim, along with a complete description of the Product, model number and alleged defect.

Limitation of Liability. 3M Purification Inc. will not be liable for any loss or damage arising from this 3M Purification Inc. product, whether direct, indirect, special, incidental, or consequential, regardless of the legal theory asserted, including warranty, contract, negligence or strict liability. Some states and countries do not allow the exclusion or limitation of incidental or consequential damages, so the above limitation or exclusion may not apply to you.

| Replacement Cartridge Options | | | | | | | |
|-------------------------------|------------|-----------------------|-------------------|-----------------------|-------|-------------------|----------------|
| Particulate Model | Load | Nominal Micron Rating | Application | | | Service Flow Rate | Max. Temp |
| | | | Particulate/ Rust | Chlorine Taste & Odor | Scale | | |
| AP1001 | Extra Fine | 1 | • | | | 8 gpm (30.3 lpm) | 100°F (37.8°C) |
| AP1003 | Extra Fine | 3 | • | | | 8 gpm (30.3 lpm) | 100°F (37.8°C) |
| AP110 | Normal | 5 | • | | | 8 gpm (30.3 lpm) | 100°F (37.8°C) |
| AP124 | Coarse | 50 | • | | | 8 gpm (30.3 lpm) | 100°F (37.8°C) |
| AP117 | Normal | 5 | • | • | | 3 gpm (11.4 lpm) | 100°F (37.8°C) |
| APS117 | Normal | 5 | • | • | • | 3 gpm (11.4 lpm) | 100°F (37.8°C) |
| AP420 | Normal | 5 | • | | • | 10 gpm (37.9 lpm) | 100°F (37.8°C) |